

Graham Blew

From: Barbara.Westmacott@kent.gov.uk
Sent: 30 September 2019 11:56
Cc: Emma.Green2@kent.gov.uk
Subject: FW: Highway Improvement Plans
Attachments: TEMPLATE - Highways Improvement Plan.docx

AGENDA ITEM 6
PTE 16/10/19

Good Morning,

Please find the attached Highway Improvement Plan template, can I ask you to completed the form and return it to me. The form can be updated annually.

The HIP is for the Parish and Town Councils to prioritise improvements that they may wish to see in their areas. We want communities to have a greater voice in prioritising road safety measures, at the same time, we need to balance requests with the money we have available to spend, making sure our investment has the most impact in making roads safer for all users. The time resource required to facilitate these individual requests can be difficult to resource.

To help us manage requests for these types of changes and improvements, we are asking parish and/or town councils to develop a Highways Improvement Plan for their areas. KCC does not have a 'pot' of funding for Parishes however this approach enables them to agree their priorities and have them collectively stored in one place and this can help in the event of personnel change at KCC. We hope they will see this as a positive step forward.

The plans give parish and town councils the opportunity to decide which community priorities they want to take forward. Given the finite KCC highways budget, not all priorities are likely to be funded. However, the Kent Highways team can discuss the problems and provide technical advice for the best way to deliver improvements and provide estimates for the costs. Using this information, parish and town councils can determine whether they can provide funding for these priorities and, working with Kent Highways, deliver them.

Many thanks,

Barbara Westmacott | Schemes Engineer | Highways, Transportation & Waste | Kent County Council | Ashford Highway Depot, Henwood Industrial Estate, Javelin Way, Ashford, TN24 8AD | Telephone: 03000 41 81 81 | | www.kent.gov.uk/highways



@KentHighways

Please consider the environment before printing this email

Total Control Panel

[Login](#)

To: graham.blew@swanscombeandgreenhithetowncouncil.gov.uk
From: barbara.westmacott@kent.gov.uk

Message Score: 1
My Spam Blocking Level: Medium

High (60): Pass
Medium (75): Pass
Low (90): Pass

[Block this sender](#)
[Block kent.gov.uk](#)

This message was delivered because the content filter score did not exceed your filter level.

Town/Parish Council - Highway Improvement Plan/Action Plan

HIGHWAY IMPROVEMENT PLAN – Stage 1		ACTION PLAN – Stage 2			
Priority	Location	Problem and suggested remedy	Cost Estimate	Funding Source	Action/Programme (Who/When)
1.	EXAMPLE: High Street between Post office and last property to the west of the garage	Speeding off peak. Reduce speed limit to 30mph	1. £500 2. £0 3. £0 4. £?	1.Parish Council 4.Parish Council	1.Traffic survey required to establish existing speeds by end of June 18.KCC to arrange 2. Review report and agree whether the site is suitable without further traffic calming measures. KCC by mid July. 3. If suitable then discuss with PC and give early advice on potential costs. Mid July 4. Agree the way forward – outline design/estimate including staff fees. Mid July
2.					
3.					
4.					

Info

From: melanie.mcneir@kent.gov.uk
Sent: 09 October 2019 11:28
To: melanie.mcneir@kent.gov.uk
Subject: Proposed diversion of part of Public Footpath DS6 at Swanscombe
Attachments: DS6.ORDERPLAN v2.pdf; 10K Network Map Sheet Printing v10.2.pdf

Dear consultee,

**Town and Country Planning Act 1990 (section 257):
Proposed diversion of part of Public Footpath DS6 at Swanscombe**

Kent County Council is now acting on behalf of the Ebbsfleet Development Corporation in relation to Public Path Orders under the Town and Country Planning Act 1990.

An application to divert a section of Public Footpath DS6 at Swanscombe has been received from Camland Developments Ltd., by whom planning permission has been sought in respect of a replacement footbridge (in the form of a new land-banked crossing) across Craylands Gorge. The footpath is currently closed to the public due to the condition of the high-level bridge across the gorge and the planning application involves the infilling of a section of the gorge in order to enable the path to reopen on a safer and more accessible route. Due to the change in levels on site, and to ensure the path is as accessible as possible, a minor diversion is required to enable the proposed development to take place.

Please find attached a draft Order plan showing the proposed diversion as well as an extract from the Definitive Map of Public Rights of Way showing the wider path network. The section of path to be diverted is shown on the draft Order plan in a solid line between points A and B, whilst the proposed new route is shown with bold black dashes between the same points. The new path will have a 'hoggin' surface with tanalised timber edging and a width of 3 metres.

I would welcome your views on this proposal and look forward to hearing from you **no later than Monday 4th November 2019.**

Please note that this is not an opportunity to object to the proposed development itself, the grant of planning permission for which is being considered by the Ebbsfleet Development Corporation in its capacity as the local planning authority. However, the County Council would welcome your views (if any) on the proposed change to the rights of way network necessitated by this development.

Should you have any queries regarding the proposal, please do not hesitate to contact me on 03000 413421.

Kind regards,
Melanie

Melanie McNeir | PROW and Commons Registration Officer | PROW and Access Service | Countryside and Community Development | Growth, Environment and Transport | Kent County Council | Invicta House, Maidstone, ME14 1XX | Tel: 03000 413421 | www.kent.gov.uk

27

This page is intentionally left blank.

559600

174600

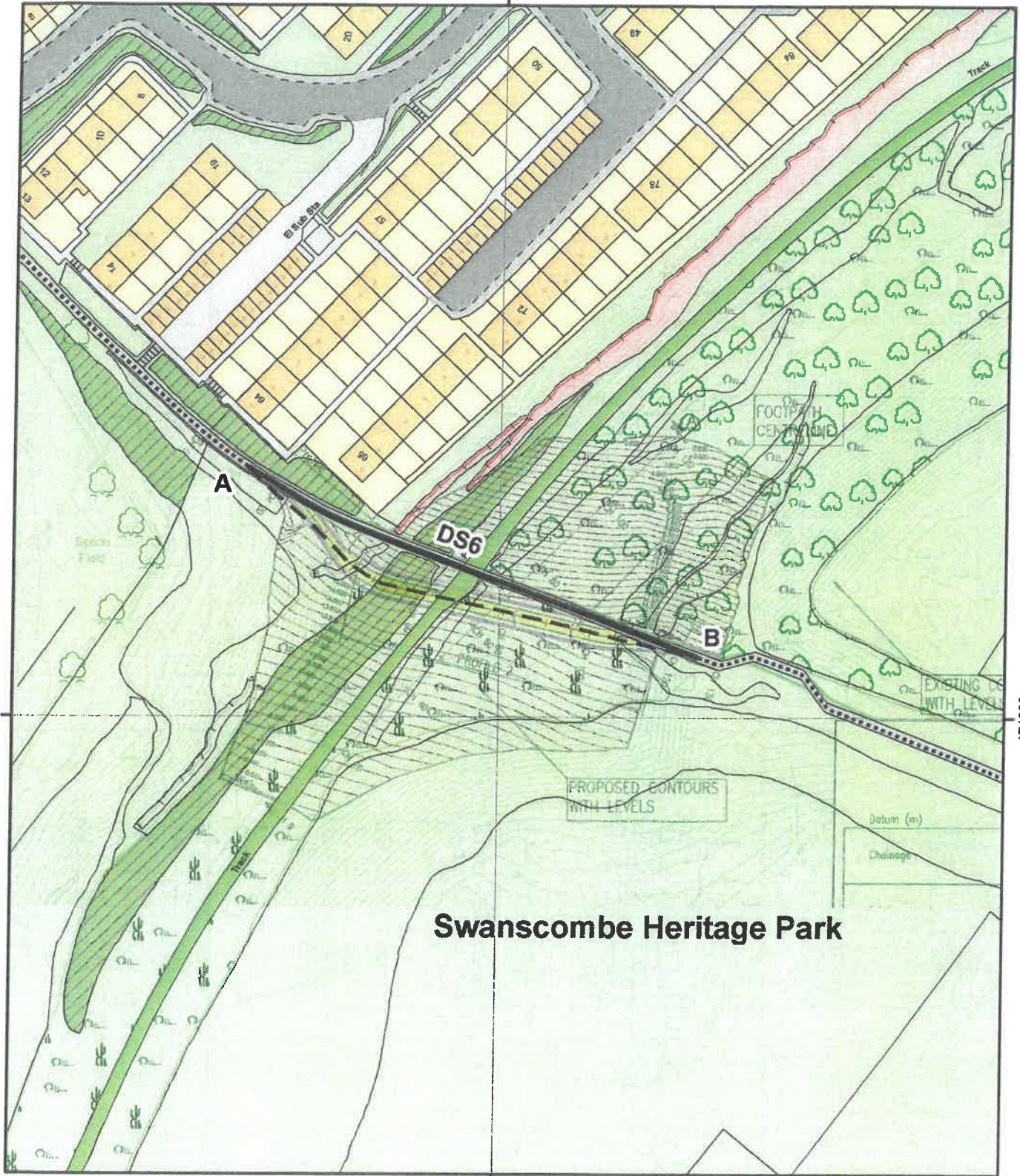

174600

559600



Swanscombe Heritage Park

Key

-  Route to be stopped up
-  Proposed new route
-  Unaffected Routes

Town and County Planning Act 1990
The Ebbsfleet Development Corporation
(Public Footpath DS6 (part) Swanscombe and Greenhithe)
DRAFT Public Path Diversion Order 2019

Produced by the KCC Public Rights of Way and Access Service.
 © Crown Copyright and database right 2019. Ordnance Survey 100019238

N



1:1250
@ A4

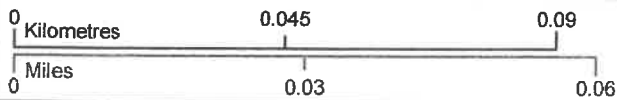

Created by: McN Checked by: CRW

Reference: PROW/DS6/0092/EDC



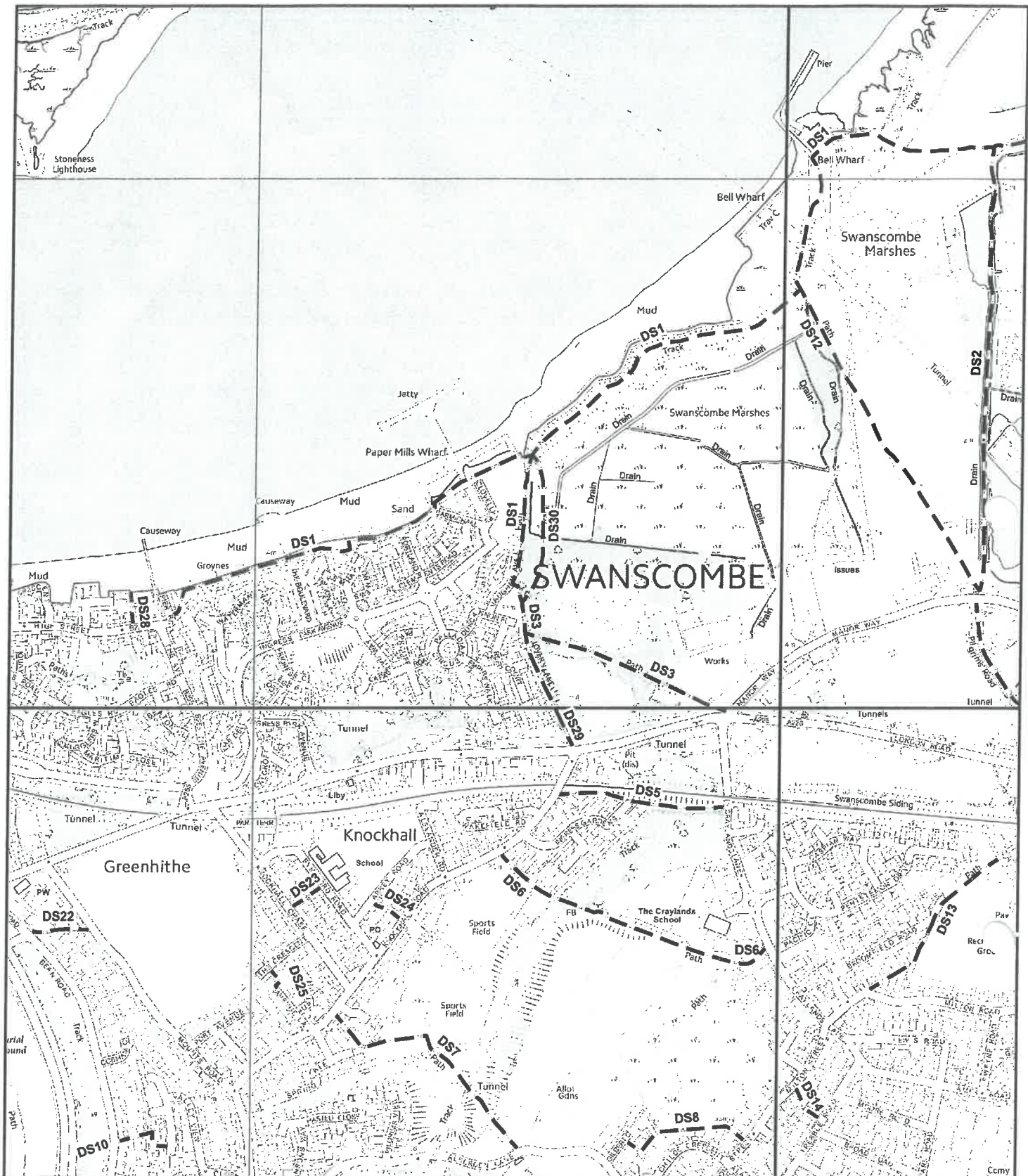

- — Footpath
- |— Bridleway
- ∨ ∨ Restricted Byway
- X X Byway Open to All Traffic
- ↗ Point path number or status changes
- ■ ■ Boundary of area covered by 1:2500 scale Network Map
- ▨ Area covered by 1:2500 scale Network Map

**EXTRACT OF THE WORKING COPY OF THE
DEFINITIVE MAP OF PUBLIC RIGHTS OF WAY
FOR THE COUNTY OF KENT**

© Crown Copyright and database right 2013. Ordnance Survey 100019238

**FOR REFERENCE ONLY – NO FURTHER COPIES
MAY BE MADE**

Unauthorised reproduction infringes Crown Copyright
and may lead to prosecution or civil proceedings.

Produced by the KCC Public Rights of Way and Access Service

Created by:
Text

Checked by:
Text

Issue Date:
14/05/2019

Reference:
Text

N

1:10,000

